

A Pair is a Pair is NOT a Pair

Carrie Goetz, D.MCO
RCDD, NTS, CDCP, CDCS, 1st Degree IM
Paige DataCom Solutions



**2018 BICSI WINTER
CONFERENCE & EXHIBITION**
Orlando, FL | February 4-8



2016 What happens in an INTERNET MINUTE?

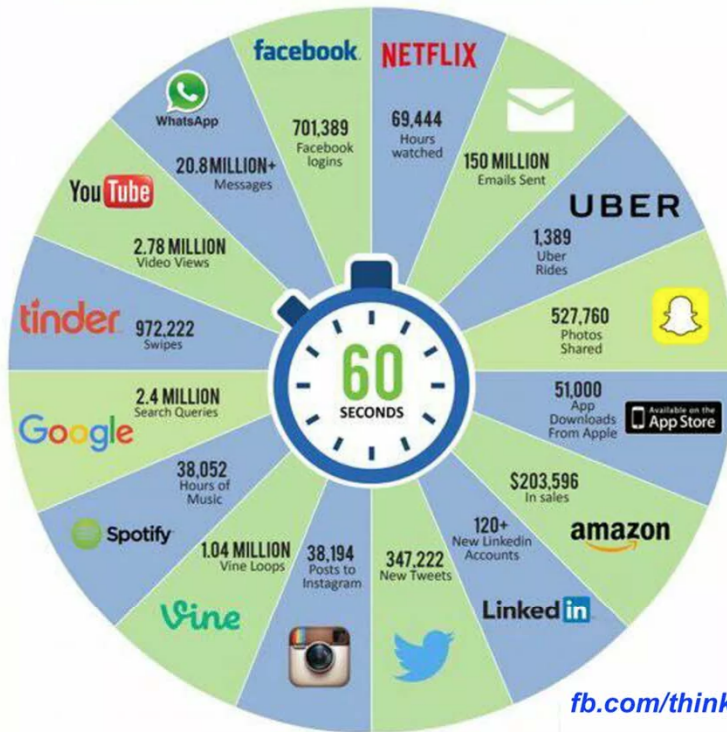

2017 This Is What Happens In An Internet Minute

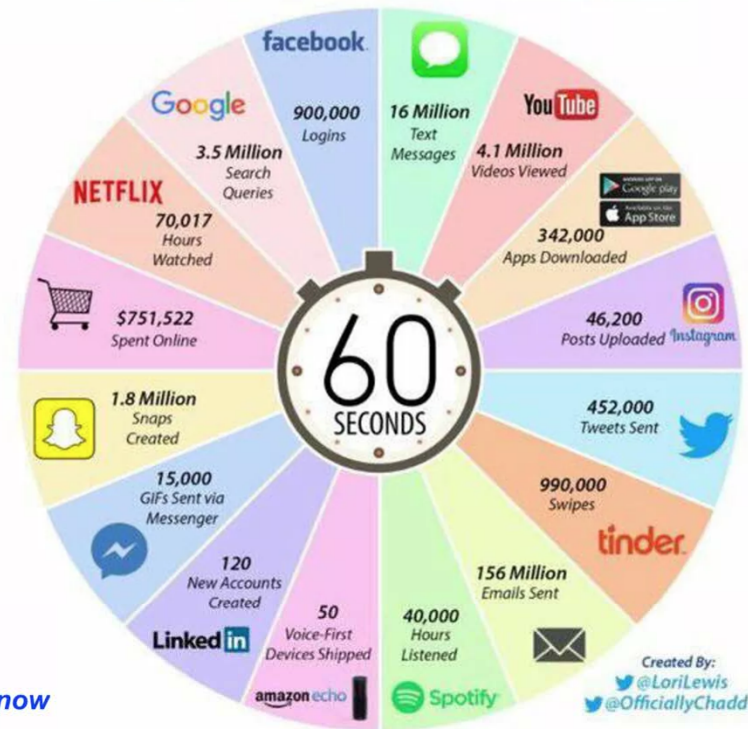

**2018 BICSI WINTER
 CONFERENCE & EXHIBITION**
 Orlando, FL | February 4-8



Gartner Says 8.4 Billion Connected "Things" Will Be in Use in 2017, Up 31 Percent From 2016

Table 1: IoT Units Installed Base by Category (Millions of Units)

Category	2016	2017	2018	2020
Consumer	3,963.0	5,244.3	7,036.3	12,863.0
Business: Cross-Industry	1,102.1	1,501.0	2,132.6	4,381.4
Business: Vertical-Specific	1,316.6	1,635.4	2,027.7	3,171.0
Grand Total	6,381.8	8,380.6	11,196.6	20,415.4

Source: Gartner (January 2017)



20
C
Orl

What are these Things?

- Sensors
- Controls
- Thermostats
- Command Chips
- Consumer Devices
- Security Devices
- Safety Devices
- Cameras
- Thermostats
- Controllers
- Lighting Controls
- Etc.!



2018 BICSI WINTER
CONFERENCE & EXHIBITION
Orlando, FL | February 4-8



Diagram by: <http://optergy.com.my/solutions/integrated-solutions/>

Integrated Building Solutions

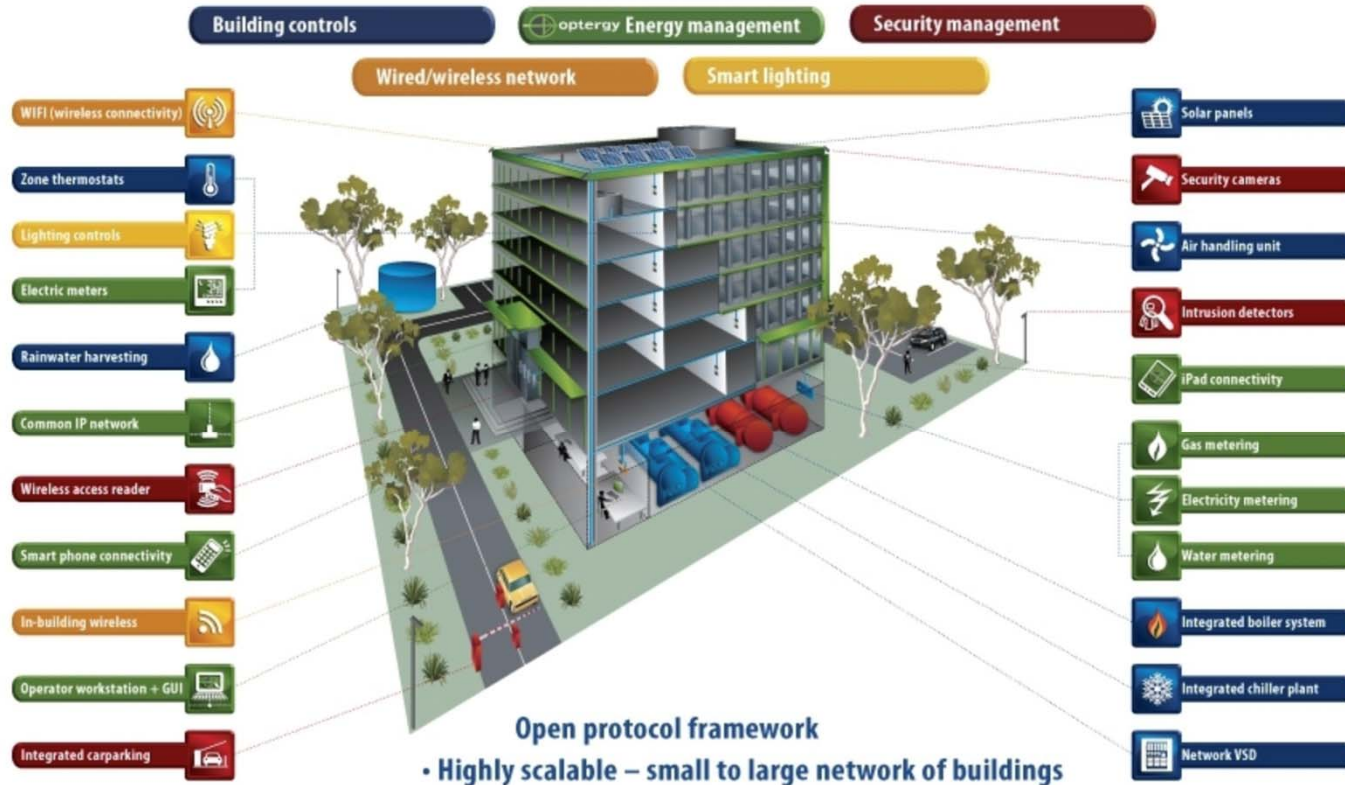

Integration to the following protocols:

Modbus

LONWORKS

BACnet®

Bicsi

Facilities

Networking

Procurement

Vendors

Security

CIO/CTO



**2018 BICSI WINTER
CONFERENCE & EXHIBITION**
Orlando, FL | February 4-8



Little Known Nuggets of Info



- Rebates and Relationships Exist
 - Who benefits?
 - Does it sway product recommendations?
 - How do you check them?
 - What value comes as a result of markup?
- What are other sources of information?
 - Power companies can be a great source and also can provide grants
 - Trade Associations
 - A&E's, Consultants



**2018 BICSI WINTER
CONFERENCE & EXHIBITION**
Orlando, FL | February 4-8



Understanding your Supply Chain



- No one works for free
- No one stocks everything
- You can benefit from flexibility
- Price several options
- Understand how the standards can work for you
- Know the difference between a code and a standard
- Know what you need ahead of time. If you are constantly reacting you are not part of the process and doomed to fail
- Know other solutions ; there is NO one size fits all



**2018 BICSI WINTER
CONFERENCE & EXHIBITION**
Orlando, FL | February 4-8

Bicsi

Myth Busters (shameless rip off) 101

- If communications are IP then you must use 4 pairs of category cable
- You must re-cable your building
- You need new systems for IoT
- You need to quintuple (at least) capacity for everything
- IoT is going to break the bank
- Plan for the worst, expect the best



**2018 BICSI WINTER
CONFERENCE & EXHIBITION**
Orlando, FL | February 4-8

Bicsi

If communications are IP then you must use 4 pairs of category cable

You can not have your fire system talk to other systems

The amount of traffic will kill my network

All communications are IP

M2M

Near field protocols

All of the IoT traffic will traverse my main network

My Vendor is the best source of information



**2018 BICSI WINTER
CONFERENCE & EXHIBITION
Orlando, FL | February 4-8**



Understand the Where, What and How of Communications

- Gateway – leaves end systems intact
 - Think translator
- Native – systems share a network (generally IP)
- Wireless is part of the equation
- Switches will determine which network
- The most secure network is one no one can get to from the outside



**2018 BICSI WINTER
CONFERENCE & EXHIBITION**
Orlando, FL | February 4-8



Make a Roadmap of Your Own

- The right vendor questionnaire
 - Ask about interoperability
 - Ask about resources available to you
 - Will the vendor support directly or will they rely on integrators/installers
 - Ask about knowledge transfer
 - Ask for direct pricing
 - Don't forget forward looking questions



**2018 BICSI WINTER
CONFERENCE & EXHIBITION**
Orlando, FL | February 4-8



Standards and Code Bodies

- ANSI/TIA/EIA North American standards
- ISO/IEC International standards
- IEEE Electronics standards
- BICSI Standards and best practices
- NEC National Electrical Code
- NFPA Fire Codes



**2018 BICSI WINTER
CONFERENCE & EXHIBITION**
Orlando, FL | February 4-8



Consortiums and .orgs

- BacNet.org
- ASHRAE
- Modbus.org
- ISOC, IAB, IESG, IETF, IRSG, IRTF



2018 BICSI WINTER
CONFERENCE & EXHIBITION
Orlando, FL | February 4-8

Bicsi

New Standards

- <https://beyondstandards.ieee.org>
 - Full section on IoT
 - Connected vehicles
 - Industry publications



**2018 BICSI WINTER
CONFERENCE & EXHIBITION**
Orlando, FL | February 4-8



Home

Categories

Beyond Standards

Contributors

Contact Us

3D Printing

5G

Aerospace

Artificial Intelligence

Augmented Reality

Autonomous Systems

Blockchain

Cloud Computing

Connected Person

Connected Vehicles

Cybersecurity

Design Automation

eHealth

Event

Green Tech

Humanitarian Efforts

IoT

NESC

Net Policy

Networking

Open Source

Power and Energy

Privacy

Robotics

Semiconductors

Sensors

Smart Cities

Smart Home

Software Define Network

Standards University

Tech Ethics

Virtual Reality

Wearables



**2018 BICSI WINTER
CONFERENCE & EXHIBITION**
Orlando, FL | February 4-8

Why It's Helpful

- Showcasing new standards applications in the marketplace
- Featuring new and emerging technologies
- Highlight innovative new areas of standards development
- Celebrate innovators and disruptors who collaborate to advance standards and technology
- Encourage participation in standards development
- Events and educational opportunities



**2018 BICSI WINTER
CONFERENCE & EXHIBITION**
Orlando, FL | February 4-8



New 1 Pair Standards

Single pair Ethernet standards under development

- 802.3bp 1000BASE-T1 (published)
 - 1 Gbps Ethernet over at least 15 m and up to at least 40 m on one pair of balanced cabling
- 802.3bw 100BASE-T1 (published)
 - 100 Mbps Ethernet up to 15 m on one pair of balanced cabling (Automotive)
- 802.3cg 10BASE-T1 (in progress, June 2019)
 - 10 Mbps Ethernet up to 1 km on one pair of balanced cabling with power target - industrial
- 802.3bu (2016)
 - power over data lines on one pair of balanced cabling
 - Class 0-9 ranging from .5 to 50W



**2018 BICSI WINTER
CONFERENCE & EXHIBITION**
Orlando, FL | February 4-8



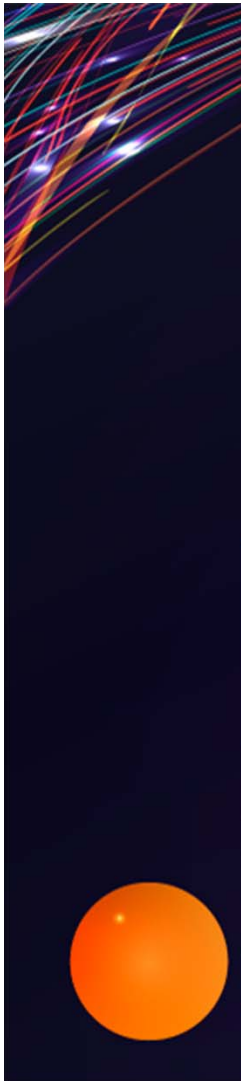

MEDIA AND MODULES

Ethernet is wired technology and supports a variety of media including backbones, twisted pair, fiber, Multirate Near and single-mode fiber. Most people know Ethernet as the twisted pair or Cat "x" cabling with RJ45 connectors because close to a billion ports a year are sold.

The graphic below shows multiple types of modules that may be used for copper or optical links. The copper modules are being developed to support ultra-high density port counts. The QSFP allows the QSFP to sit on an SFP site while the QSFP-ED enables the same court to 8 On Board (OS) enable the highest port counts or densities.

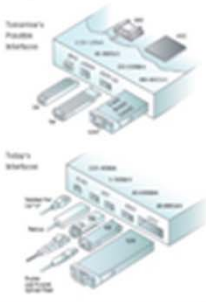

2016 ETHERNET ROADMAP

THE PAST, PRESENT AND FUTURE OF ETHERNET

ETHERNET SPEEDS

Legend: ● Standard ● In Development

www.ethernetalliance.org

Designed by Scott Kipp
© Ethernet Alliance, LLC. All rights reserved.
EA 15

2016 ETHERNET ROADMAP

FLEX ETHERNET (FLEXE)

Defined by the Optical Networking Forum (ONF), FlexE is often called a new generation of Link Aggregation (LAG) and may provide a path to speeds higher than 400G without an IEEE standard. Proponents of FlexE claim that higher speeds like 800Gbit are not necessary since these speeds just equate to many times that run at lower speeds. FlexE can aggregate individual Ethernet links and create a FlexE Plac that connects to another FlexE Plac. The illustration below shows a 300G FlexE group that bonds the 300Gbit links together.

The FlexE Group refers to a group of from 1 to a bonded Ethernet Plac. A FlexE Client is an Ethernet flow based on a MAC data rate that may or may not correspond to any Ethernet PHY rate. The FlexE Client is the layer that maps or demaps the FlexE clients carried over a FlexE group. In the example illustration below, three 100Gbit and one 300Gbit FlexE clients connect over the transport network via a FlexE Group that supports 300Gbit of bandwidth over 2 wavelengths of 100Gbit.



- Ethernet Speed
- Speed In Development
- Possible Future Speed



ETHERNET INTERFACES AND NOMENCLATURE

	Electrical Interface	Backplane	Form-factor	Twisted Pair	HW	Portlet port	Non-SFP	SFP SFP	Other SFP
10BASE-T				T					
100BASE-TX				Tx	Px			LX	
100BASE-SX		XX	ZK	Y	SA			LX	
25GBASE-S		XX		Y					
50GBASE-S		XX		Y					
100BASE-SR10	SR1, SR2	XXA, XR	CR	T	SR			LR	ER
200BASE-SR40	SR40A	XX	CR	T	SR			LR	ER
400BASE-SR80	SR80	XXA	CR	T	SR			LR	ER
800BASE-SR160	SR160A-01	XX	CR		SR			LR	ER
1000BASE-CAX10	CAX10	XXA, XR2	CRXL		SR10	PSM4	XX10	LX10	EX10
1000BASE-CAX4	CAX4	XXA	CR		SR4		XX10	LX10	EX10
1000BASE-CAX2	CAX2		CR2		SR2		XX10	LX10	EX10
2000BASE-CDM40	CDM40	XXA	SR		SR		XX10	LX10	EX10
4000BASE-CDM16	CDM16	XXA	SR		SR16	XX16	XX10	LX10	EX10

Gray Text = IEEE Standard Red Text = In Standardization Green Text = Under consideration in IEEE
Blue Text = Non-IEEE standard but complies to IEEE electrical interfaces

To get a PDF version of the roadmap and to find out more about the roadmap, please go to: www.ethernetalliance.org/roadmap/



<http://optergy.com.my/solutions/integrated-solutions/>

Integrated Building Solutions

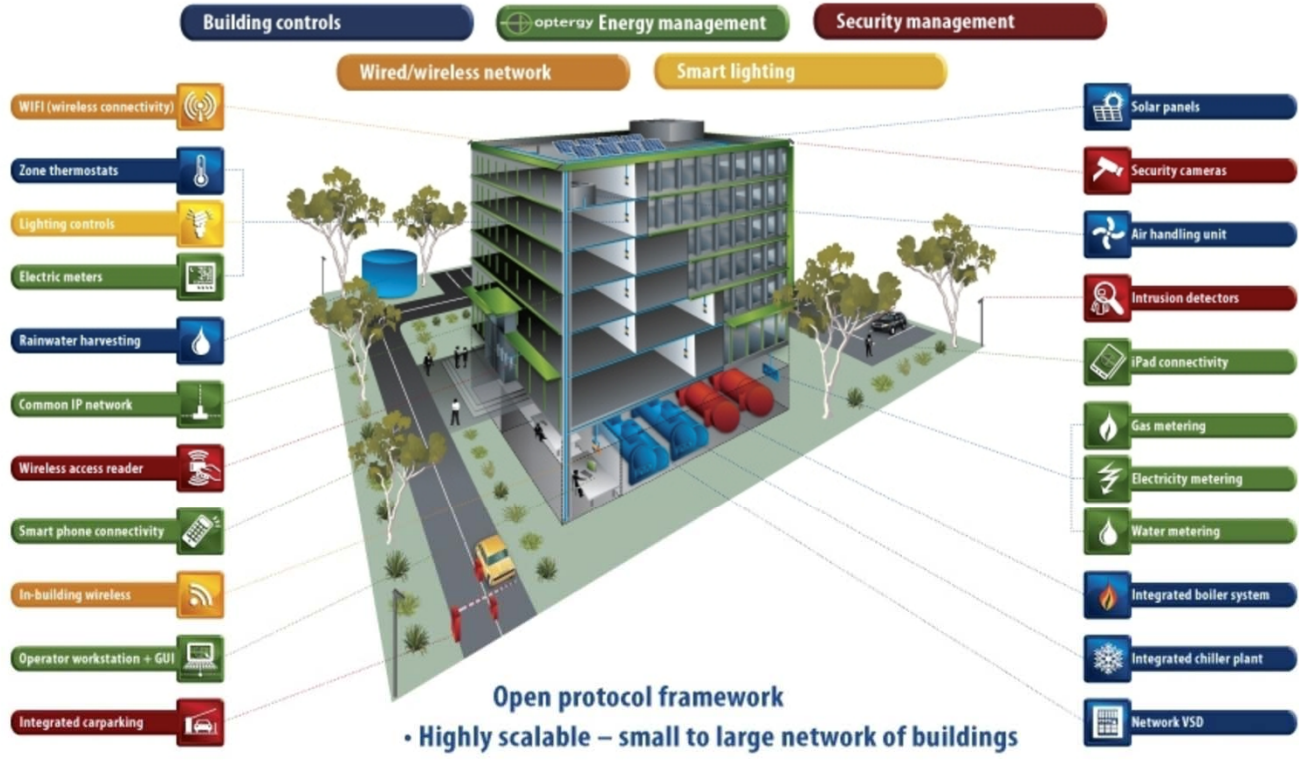

Integration to the following protocols:

Modbus

LONWORKS

BACnet®

Bicsi

IoT and Types of Communication

M2M (Machine 2 Machine)

Nearfield communications

ZigBee, RFID, Bluetooth, BACnet, ANT
802.15.4e, LoRaWAN, 6LoWPAN, RPL, CoAP,
MiWi, ISA100.11a, Wireless HART, etc.

Cellular



**2018 BICSI WINTER
CONFERENCE & EXHIBITION**
Orlando, FL | February 4-8



A Quick Word about Wireless

- Pay attention to the environment
- Saturation can be an issue
- Multipath can cause problems
- As communication needs increase, balance will be key
- Don't assume that grids automatically work



2018 BICSI WINTER
CONFERENCE & EXHIBITION
Orlando, FL | February 4-8



NEC 240-3

- Continuous loads
- Conductor ampacity
- Terminal temperature ratings
- System voltage
- Conductor insulation
- Special application
- Power Loss Hazard
- Fire Alarm System Circuit Conductors
- Devices Rated 800 Amperes or Less
- Remote-Control, Signaling, and Power-Limited Circuit Conductors
- Tap Conductors
- Transformer Secondary Conductors
- Motor-Operated Appliance Circuit Conductors
- Air-Conditioning and Refrigeration Equipment Circuit Conductors
- Motor and Motor-Control Circuit Conductors
- Phase Converter Supply Conductors
- Capacitor Circuit Conductors
- Electric Welder Circuit Conductors



**2018 BICSI WINTER
CONFERENCE & EXHIBITION**
Orlando, FL | February 4-8



How far can it go?

- Distances shown versus category cable- 8 stands (4 pair) $\leq 100\text{m}$
- Category cable limited to 100m for Ethernet

Volt Ampere (VA) at 24VAC

Wire Size	Device VA	Maximum Length (feet)
16 AWG	100	100
	75	150
	50	250
	25	500
18 AWG	50	150
	25	300
	15	500
	5	1000



**2018 BICSI WINTER
CONFERENCE & EXHIBITION**
Orlando, FL | February 4-8



Door Controls

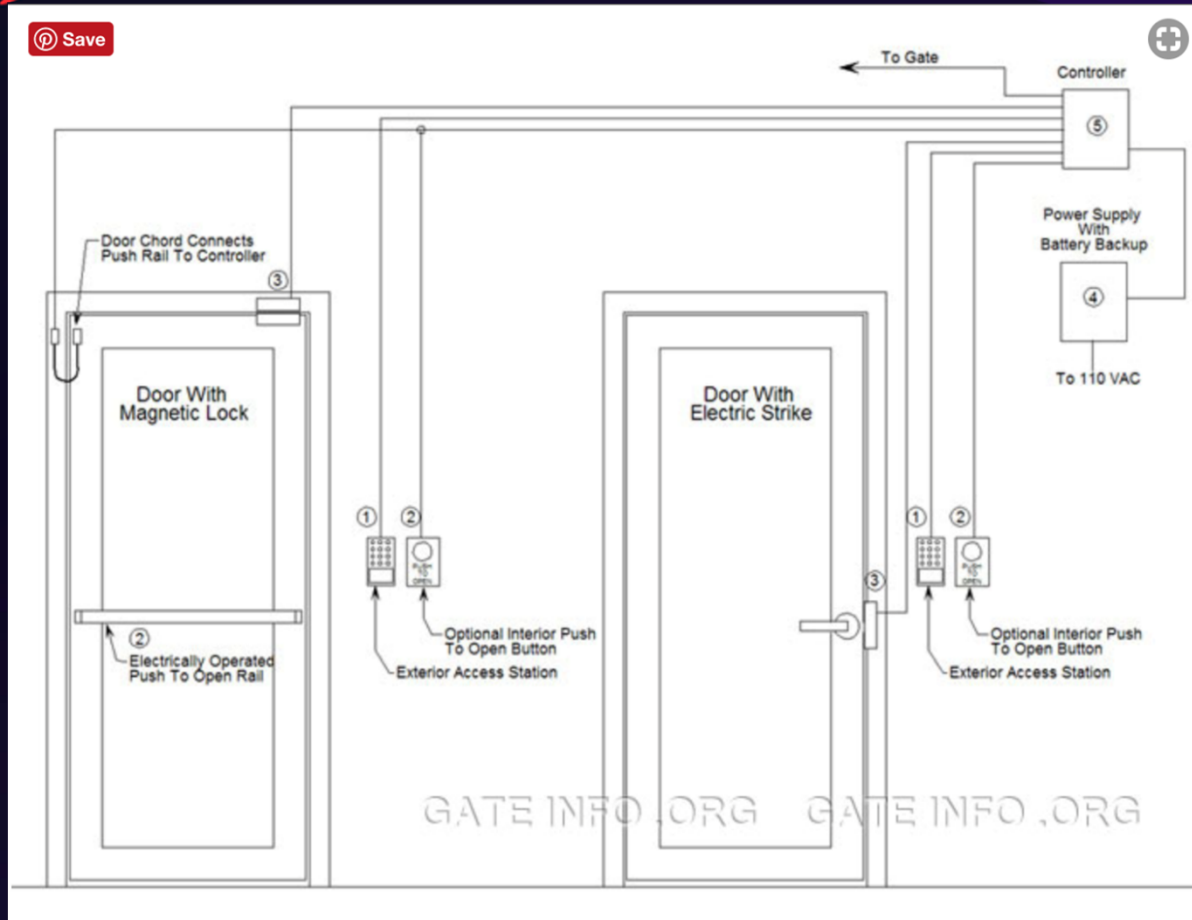

Are all Cables the Same?

- Electrically different
- Conductor size depends on power and signal
- Composite cables lower labor
- Will talk to different systems
- Category 5E or 6 cables can NOT run everything in an intelligent building
- 4 Category cables = 4 sets of twisted pairs
- Not all conductors are the correct size
- Waste of unneeded pairs/conductors
- 32 conductors when 16 are required
- Will still need control cables for electrical reasons



**2018 BICSI WINTER
CONFERENCE & EXHIBITION**
Orlando, FL | February 4-8



Bicsi

Thermostat

- 16 or 18 AWG 4/5 strand wire to thermostat
- 1 Thermostat / 5 offices = $\sim 1/500\text{sq}'$



2018 BICSI WINTER
CONFERENCE & EXHIBITION
Orlando, FL | February 4-8



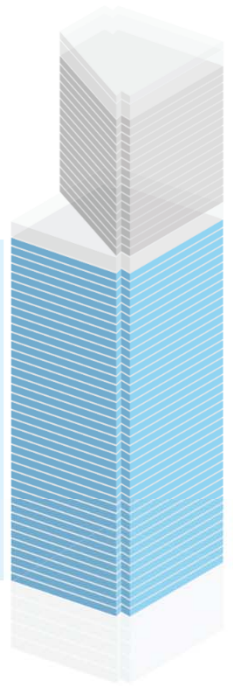
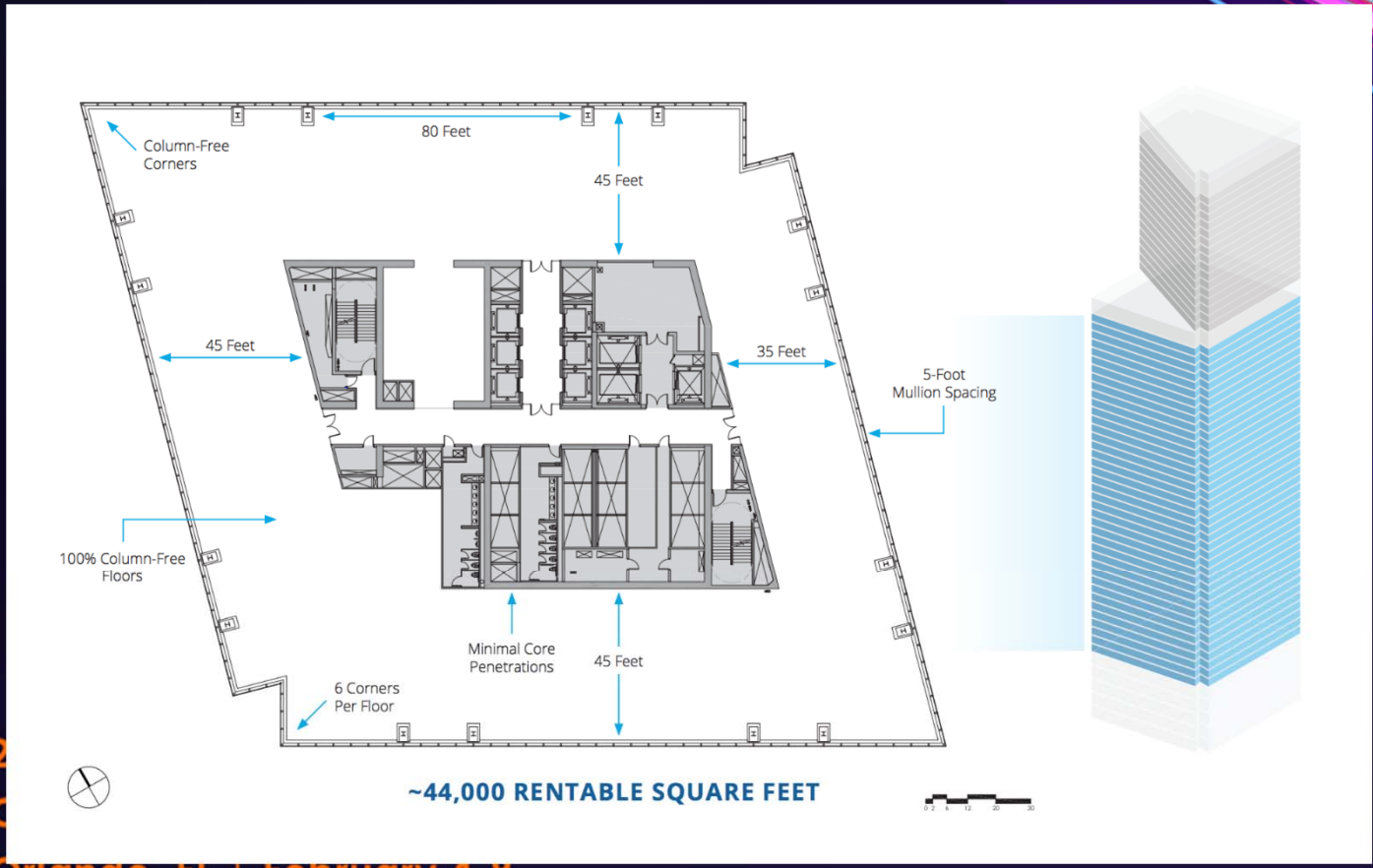

2
C
Orlando, FL | February 4-8





Table 2. Test Results from TIA TR-42 and ISO/IEC

TIA TR-42 Recommendation			ISO/IEC Recommendation		
Temperature Rise	Max Current per twisted Pair	Max Power @ 50V	Temperature Rise	Max Current per twisted Pair	Max Power @ 50V
5	420mA	37.5W	5	420mA	37.5W
7.5	520mA	45.2W	7.5	550mA	47.4W
10	600mA	51.0W	10	600mA	51.0W
12.5	670mA	55.8W	12.5	680mA	56.4W
15	720mA	59.0W	15	720mA	59.0W

With maximum 51W UPOE capacity, temperature for 100-cable bundle increased 10 degrees. This is as required by PoE Plus cable standard request defined in 802.3at.



20
C
Orlando, FL | February 4-8



PoE, PoE+, PoE++, LP Cable

LP Cabling is not required
 May prevent some testing, but TBD
 Bundling constraints based on power

AWG	Number of 4-Pair Cables in a Bundle																				
	1			2-7			8-19			20-37			38-61			62-91			92-192		
	Temperature Rating			Temperature Rating			Temperature Rating			Temperature Rating			Temperature Rating			Temperature Rating					
	60°C	75°C	90°C	60°C	75°C	90°C	60°C	75°C	90°C	60°C	75°C	90°C	60°C	75°C	90°C	60°C	75°C	90°C	60°C	75°C	90°C
26	1	1	1	1	1	1	0.7	0.8	1	0.5	0.6	0.7	0.4	0.5	0.6	0.4	0.5	0.6	NA	NA	NA
24	2	2	2	1	1.4	1.6	0.8	1	1.1	0.6	0.7	0.9	0.5	0.6	0.7	0.4	0.5	0.6	0.3	0.4	0.5
23	2.5	2.5	2.5	1.2	1.5	1.7	0.8	1.1	1.2	0.6	0.8	0.9	0.5	0.7	0.8	0.5	0.7	0.8	0.4	0.5	0.6
22	3	3	3	1.4	1.8	2.1	1	1.2	1.4	0.7	0.9	1.1	0.6	0.8	0.9	0.6	0.8	0.9	0.5	0.6	0.7



**2018 BICSI WINTER
 CONFERENCE & EXHIBITION
 Orlando, FL | February 4-8**



Cable Considerations

- Don't run more than you need if there is not a real possibility that you will use it.
 - Don't run 4 pair cables if two will due long term
 - Know your distances
 - Sometimes it pays to operate outside of the standards



2018 BICSI WINTER
CONFERENCE & EXHIBITION
Orlando, FL | February 4-8



CCTV change to IP

- RG cables go approximately 750'
- Traditional category cables go 100m (328')
- Video Optimized cable 850' with PoE+

VIDEO OPTIMIZED CABLE 850'

750'

328'

MUST ADD IDF AND/OR REPEATER



**2018 BICSI WINTER
CONFERENCE & EXHIBITION**
Orlando, FL | February 4-8

Bicsi

Cost with Transceivers

Materials from 328' to 750'		Each	Extended	Additional Cost per Run
2	Cost of Tranceiver	\$ 800.00	\$ 1,600.00	
2	Cost to Add Power	\$ 250.00	\$ 500.00	
422	Additional Fiber, connectors, etc.		\$ 506.40	
			\$ 2,606.40	\$ 2,006.40
	Additional IDFs			
3	Power, Switch, Enclosure	\$ 1,500.00	\$ 4,500.00	\$ 3,900.00
	Cable Option			
1000'	Cost of Video Optimized Cable		\$ 600.00	\$ -

- GameChanger Cable Optimized for Video 850' no repeater



**2018 BICSI WINTER
CONFERENCE & EXHIBITION**
Orlando, FL | February 4-8



Doors Only



2018 BICSI WINTER
CONFERENCE & EXHIBITION
Orlando, FL | February 4-8

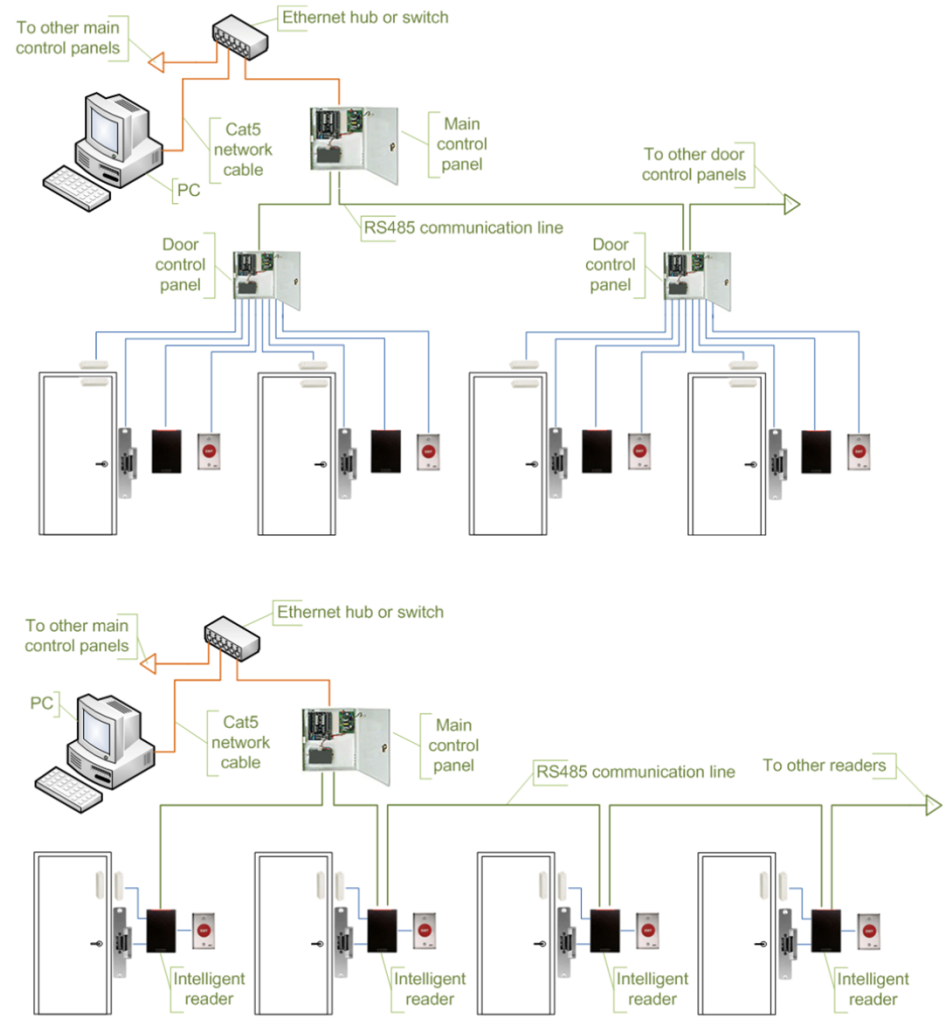

Composite Cable Example

ACCESS CONTROL

ALL-IN-ONE / COMPOSITE CABLE

- 6 CONDUCTOR 18 AWG SHIELDED – **Reader**
- 4 CONDUCTOR 18 AWG SHIELDED – **Rex/Motion**
- 2 CONDUCTOR 16 AWG SHIELDED – **Lock Power**
- 4 CONDUCTOR 22 AWG SHIELDED – **Door Contact**

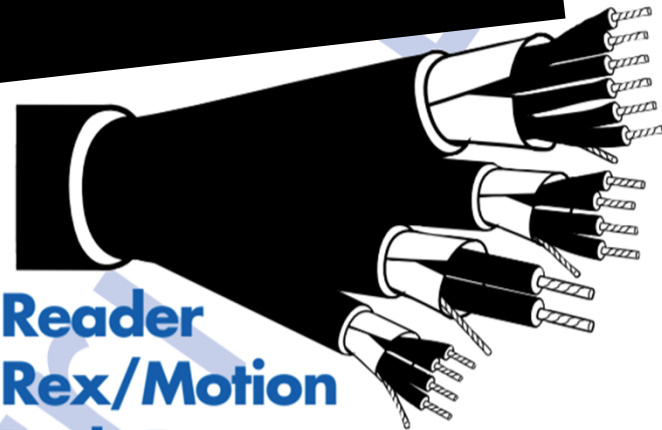

2018 BICSI WINTER
CONFERENCE & EXHIBITION
Orlando, FL | February 4-8

Bicsi

Not all Composites are the Same

- You must verify all components
- Look at shielding of all components
 - Unshielded cables next to magnetic doors
 - Unshielded cables next to noise sources
 - Not all of these cables are balanced
 - Not all pairs are twisted



2018 BICSI WINTER
CONFERENCE & EXHIBITION
Orlando, FL | February 4-8



NEC Sections

- Article 725 – Remote Control, Signaling Circuits
- Article 770 Optical Fiber Cables and Raceways
- Article 800 Communications Circuits
- Article 820 Community Antenna Television (CATV)



**2018 BICSI WINTER
CONFERENCE & EXHIBITION**
Orlando, FL | February 4-8



Coatings and Jackets

- Not limited to plenum and riser
- Ceramic Reactive Coatings for Fire
 - Circuit Integrity Cable
 - Turns to ceramic when exposed to Fire/Water
 - Maintains integrity of circuit for 2 hours
 - Higher hour ratings require conduit encasement



**2018 BICSI WINTER
CONFERENCE & EXHIBITION**
Orlando, FL | February 4-8



New Circuit Integrity Requirements

- 72.F requirements section 3.3.188 which states “the ability of a conductor, optic fiber, radio carrier, or other means for transmitting system information to remain operational during fire conditions. The required functionality is tested and verified by UL 2196 and is one of the most stringent tests conducted to verify operation during fire events



**2018 BICSI WINTER
CONFERENCE & EXHIBITION**
Orlando, FL | February 4-8



Shielded and Not Shielded Applications

- Composite Cables may or may not have the right combination
- Vary within states/countries due to governance
- Not having a shield for some applications is a big thing



2018 BICSI WINTER
CONFERENCE & EXHIBITION
Orlando, FL | February 4-8



Why you Don't Need Category Everywhere

- Wasted pairs
- Electrically insufficient
- Code insufficient
- Application insufficient



2018 BICSI WINTER
CONFERENCE & EXHIBITION
Orlando, FL | February 4-8



Do We Need IP Everywhere?

- Many kinds of data and protocols
- Not all are IP
- Not all are needed



2018 BICSI WINTER
CONFERENCE & EXHIBITION
Orlando, FL | February 4-8



Miscellaneous Protocols

- Consider a gateway
- Consider if solution sets will do
- Consider whether real-time communications between systems is needed
- Reach out to your vendor/integrators and ask about solutions
- Do your own research!
- Beware over planning for information that will not hit your data center



**2018 BICSI WINTER
CONFERENCE & EXHIBITION**
Orlando, FL | February 4-8



A word about the information

- Not all information is useful
- The more you store the more you have to process
- Some information will be M2M only
- The more you capture, the more you will want to capture
- Give info a litmus test
 - Is it useful?
 - Is it actionable?
 - Can it be measured?
 - Can changes be measured?
 - Is it in your disaster recovery/business continuity plan?



**2018 BICSI WINTER
CONFERENCE & EXHIBITION
Orlando, FL | February 4-8**

A magnifying glass with a black handle and silver frame is positioned over a word cloud. The word 'INFORMATION' is the largest and most prominent, rendered in red. Other words in the cloud include 'DOCUMENT', 'TECHNOLOGY', 'GUIDANCE', 'WORD', 'DIRECTIVE', 'DOSSIER', 'PERCEPTION', 'FACTS', 'DEVELOPMENT', 'KNOWLEDGE', 'RECOMMENDATION', 'STUDY', 'PERCEPTION', 'INFO', 'WISDOM', 'EACH', 'OL', 'ADVISE', 'MODERN', 'ACTS', 'CH', 'WORD', 'INFO', 'IS', 'TH'.

Bicsi

Build a Chart – Expect it to Change

- What information will be gathered by each system
- Where will that information be stored?
 - Locally
 - Centrally
 - Cloud
- How long will it need to be stored?
- Will the information need to be backed up?
- What other systems will interface with each system?
- Will the interfaces require full information or partial information?



**2018 BICSI WINTER
CONFERENCE & EXHIBITION**
Orlando, FL | February 4-8



Bicsi

Information you don't need...

- Personal device information
- Active Noise (calls, etc.)
- Passive noise (M2M)
- Nearfield Communications (maybe)



2018 BICSI WINTER
CONFERENCE & EXHIBITION
Orlando, FL | February 4-8



What is Near-field Communication?

- Generally mobile device to fixed device
- Generally quick bursts of data
- Normally command based



**2018 BICSI WINTER
CONFERENCE & EXHIBITION**
Orlando, FL | February 4-8

www.nearfieldcommunication.org

Bicsi

Near Field Hybrid Example

- Apple Pay
- Phone communicates to reader (Near Field)
- Reader processes payment (Network Communication)



**2018 BICSI WINTER
CONFERENCE & EXHIBITION**
Orlando, FL | February 4-8



Data Center Considerations

- Segmentation of networks
- Amount of storage
- Location of data
 - Cloud?
 - Colo?
 - In house?



**2018 BICSI WINTER
CONFERENCE & EXHIBITION**
Orlando, FL | February 4-8



Considerations for Location of Data

- Latency
- Availability
- Interfaces with other data/systems
- Longevity
- Privacy
- Personally identifiable information



**2018 BICSI WINTER
CONFERENCE & EXHIBITION**
Orlando, FL | February 4-8



Bicsi

How Many Data Centers

- Edge
- Centralized
- Warm/Hot site
- Some combination
- Data Centers in 2018 will be different!



**2018 BICSI WINTER
CONFERENCE & EXHIBITION**
Orlando, FL | February 4-8



Conclusions

- Determine what devices will be on or near your networks
- Plan for the bandwidth within reason
- Plan for changes – status as usual won't work
- Don't plan in a vacuum
- Be prepared to reevaluate often



2018 BICSI WINTER
CONFERENCE & EXHIBITION
Orlando, FL | February 4-8





QUESTIONS?

CGOETZ@PAIGEELECTRIC.COM

@CARRIEJGOETZ



2018 BICSI WINTER
CONFERENCE & EXHIBITION
Orlando, FL | February 4-8

